

## Descriptions:

Model **YX-SGH-22-25** is a standard gain horn antenna that operates from 33~50 GHz, it is linear polarization, The RF port is equipped with wave-guide flange which is optional.

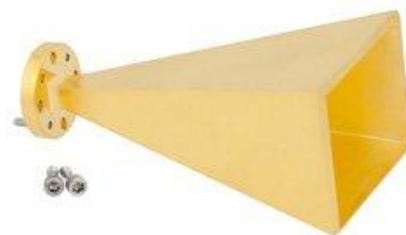

## Features:

- Wide-band Frequency, High Gain
- Excellent Directional, linear Polarization
- Lightweight, high reliability, and long lifespan

## Applications:

- Antenna Communication System
- Antenna Measurement and Calibration
- Research and Experimentation



### Electrical & Environmental Characteristics

Frequency	33-50GHz
Gain	25 dB typical
VSWR	1.25 max
Polarization	Linear
E-Plane 3 dB Beam width	8.5 to 5 degrees
H-Plane 3 dB Beam width	11 to 7 degrees
Cross Polarization	-25dB max
Power Handling	15W(cw)
Specification Temperature	+25℃
Operating Temperature	-40℃~+85℃

### Mechanical Specifications

Antenna port	WR10 Waveguide
Flange	UG383/U-M
Material	Brass
Finishing Inside and Outside	Gold plating inside and outside
Size	154.18*54.03 * 67.04mm
Weight (approx.)	/

### 33~50GHz Standard Gain Horn Antenna with WR22 Wave-guide Port P/N: YX-SGH-22-25

**Outline Drawing(Unit: mm):**

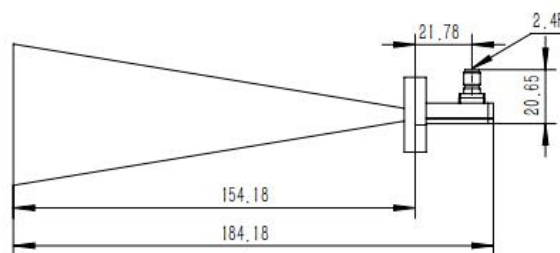
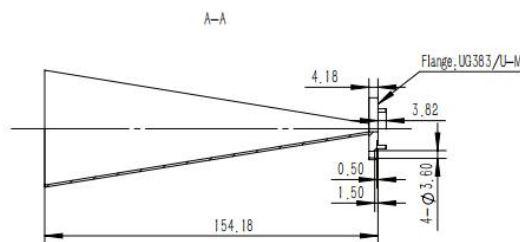
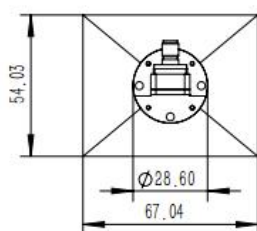
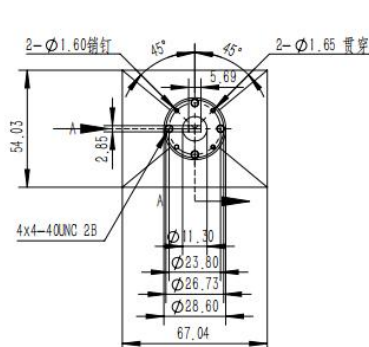

## VSWR VS Frequency

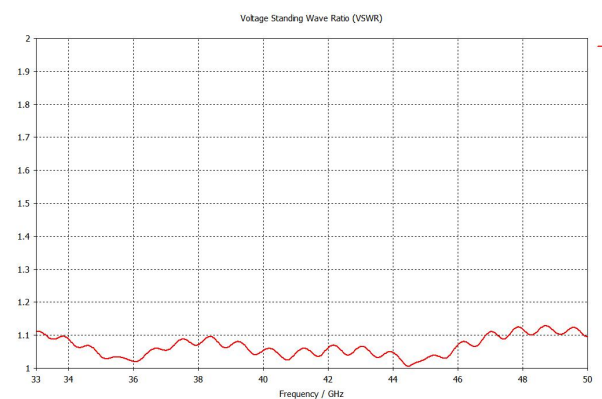

### 3dB Beam width

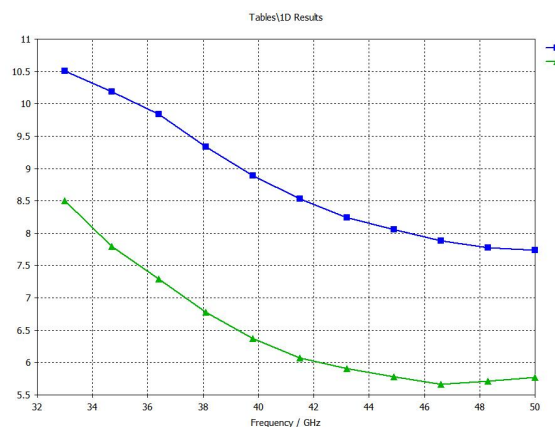

## Gain VS Frequency Plots

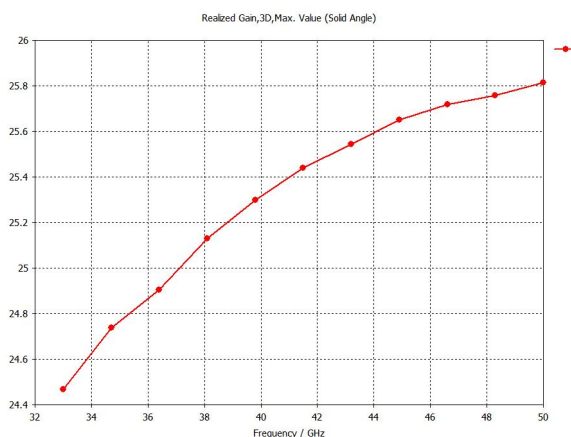

Notice:All of the aborning data is simulation for reference.

YERSON and its affiliates reserve the right to make changes to the products or information contained herein without prior notice. Please visit [www.yersontech.com](http://www.yersontech.com) for additional data sheets and product information.