

Features

- Covering frequencies from 8.2 to 12.4GHz
- Directional, linear Polarization
- Reliable gain, low standing wave.
- Lightweight, high reliability, and long lifespan

Typical Applications

- EMI detection, direction finding, and reconnaissance
- Measurement of antenna gain and pattern



Electrical & Environmental Specifications

Operating Frequency	8.2-12.4 GHz
Gain	15dB typical
VSWR	1.25 max
3dB Beamwidth-Horizontal	29 degrees
3dB Beamwidth-Vertical	29.3 degrees
Operating Temperature	-30°C~+55°C

Mechanical Specifications

Waveguide Option	WR90
Flange Type	UG39/U, UG40B/U, PBR100(Optional)
Material	Aluminum
Inside Finish	Oxidation inside
Outside Finish	Blue painting
Weight	/
Sizes (mm)	52.7*70.7*138.7mm

Outline Drawing

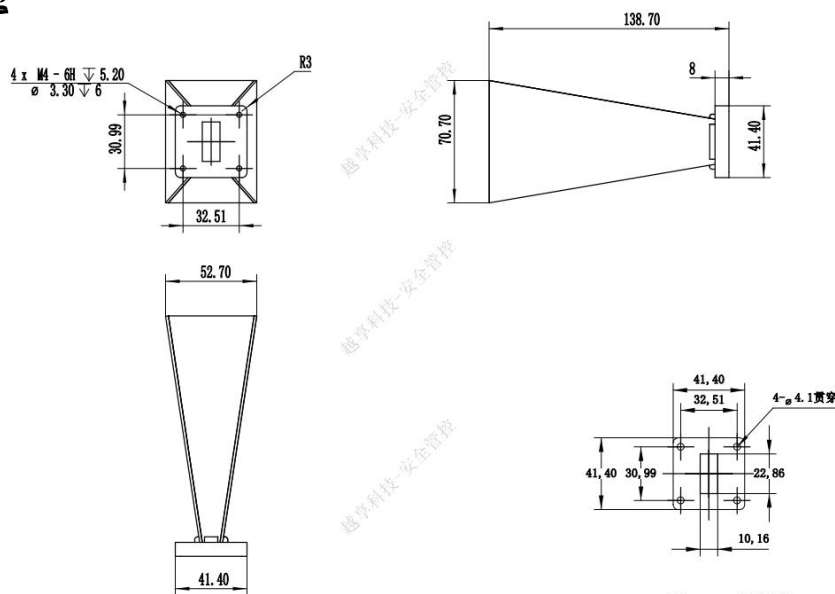

Gain VS Frequency Plots

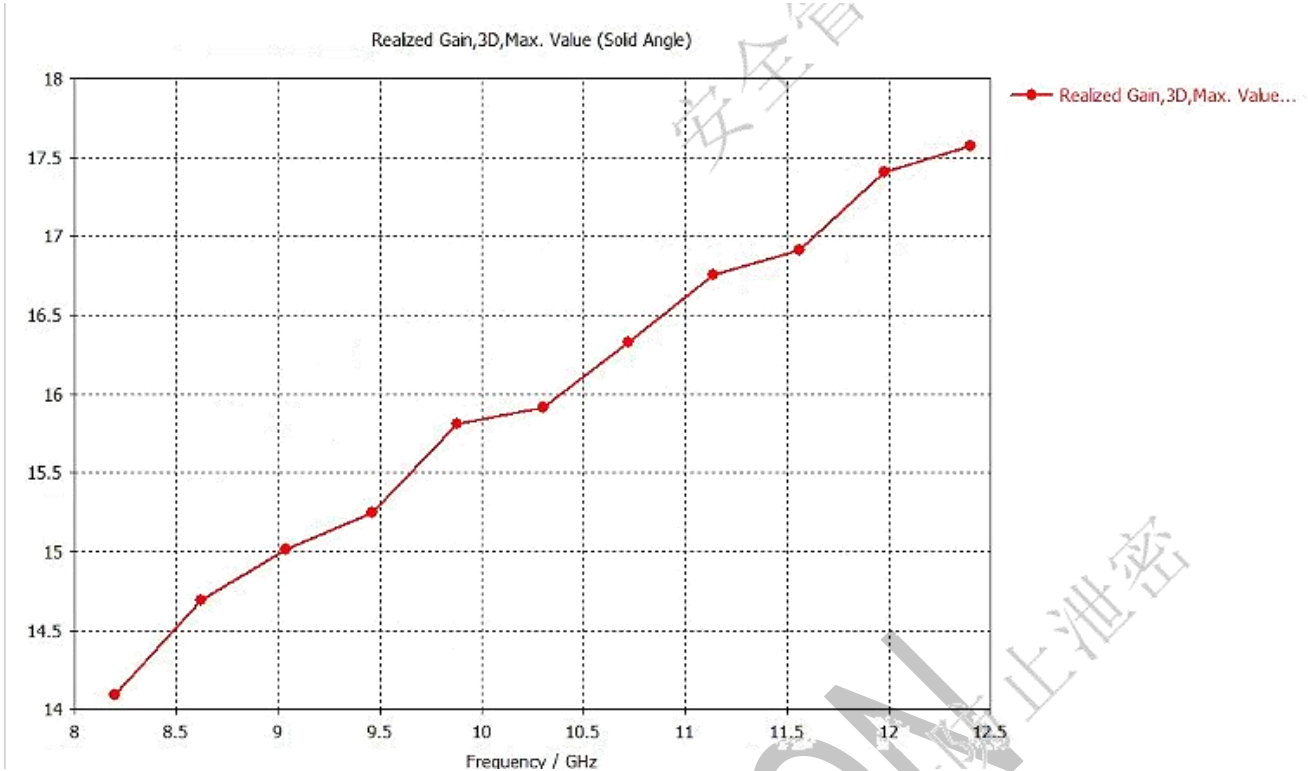

Input VSWR VS Frequency

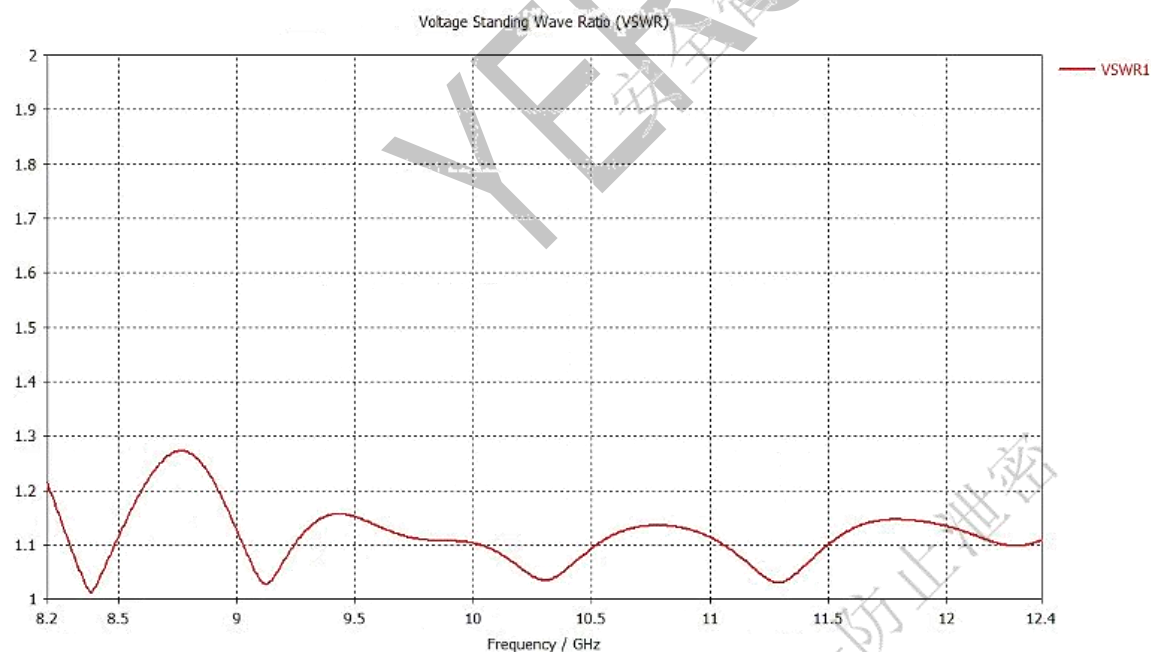

Notice: All of the above data is simulation for reference.