

Cable connector

P/N:2.92-JHE086

Features:

- Up to 40GHz
- Compatible cable:RG405

Electrical Specifications:

Item	Specification
Impedance	50Ω
Operating frequency range	DC-40GHz
VSWR	≤1.30
Dielectric withstand voltage	500V rms
Insulation resistance	≥5000MΩ

Structural Materials and Plating:

Structure	Material and plating
Body	Stainless steel,Passivated
Dielectric	PEI1000
Contact Pin	Beryllium copper,Gold plated

Environmental&Mechanical specifications:

Item	Specification
Temperature range	-55℃ to+125℃
Durability	≥500 cycles
RoHS	Compliant

Cable connector

P/N:2.92-JHE086

Outline Drawing:

All Dimensions in mm:

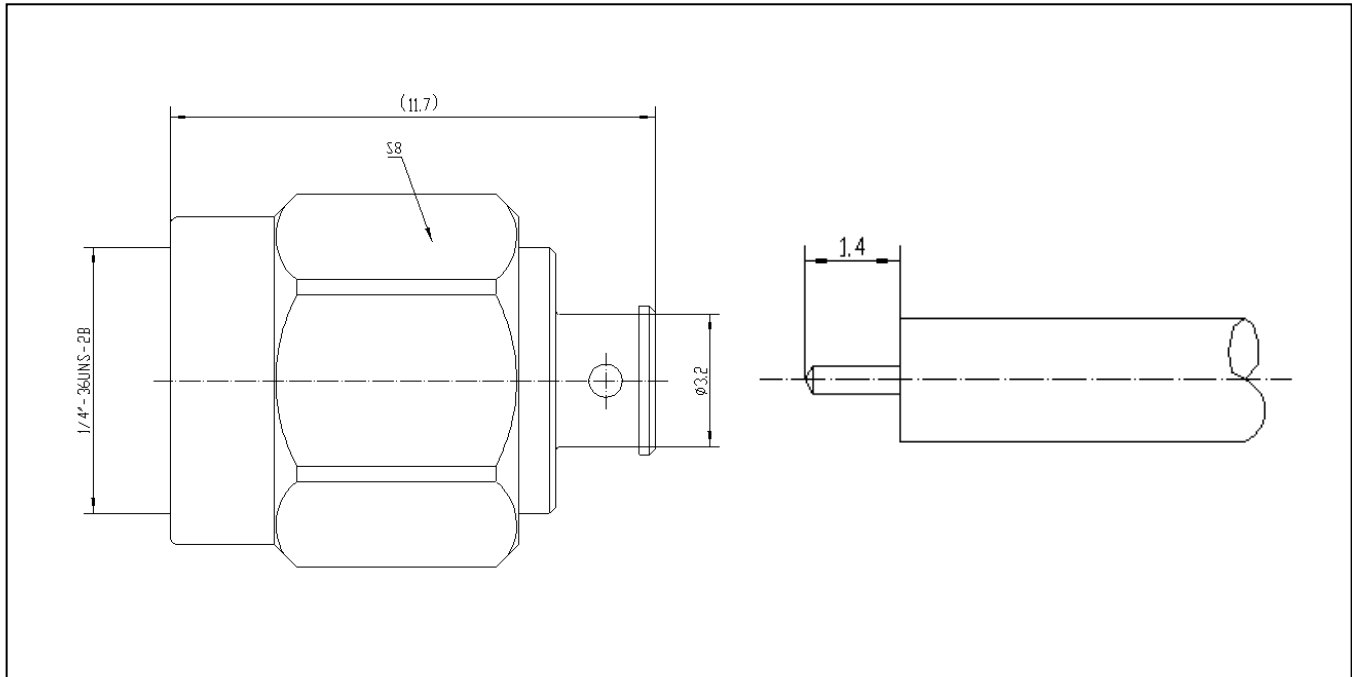

YERSON and its affiliates reserve the right to make changes to the products or information contained herein without prior notice. Please visit www.yersontech.com for additional data-sheets and product information.